

SEPT - MEETING AGENDA

DATE:

TUESDAY, SEPT. 8, 2020

WHERE:

This will be a [virtual online meeting](#)

5:00 PM - 6:00 PM

Plumbing Sizing 101 - Pipe Sizing

6:00 PM - 7:00 PM

Hunter's Curve and the Future of Plumbing Sizing

Please note: the price is free.

(If you are having trouble logging in for nonmembers who need to create an account: <https://education.aspe.org/moreinfo>) The time shown on the information page is in Central Time due to ASPE's admin settings. When you login and if you're in a different time zone it will adjust.

REGISTRATION REQUIRED

Registration link: <https://education.aspe.org/products/eastern-michigan-chapter-meeting-plumbing-sizing-101-hunters-curve-and-the-future-of-plumbing-sizing-sept-2020>

REGISTRATION IS FREE

SEE INSIDE COVER FOR TABLE OF CONTENTS

From Pam Hartsell, CPD President of ASPE EMC



Hello Eastern Michigan Chapter and welcome to a new program year! I am honored to be serving as your chapter president this year and I look forward to your participation and feedback. The Chapter Board of Directors is here to serve you, so please let us know if you have any suggestions.

I want to sincerely thank Immediate Past President Theresa Card for her leadership, mentorship and tireless effort as our (returning) VP Technical. She, along with our Master Editor Theresa Green, planned, organized and published another fantastic calendar of events for the upcoming program year.

I would like to thank all of our returning board members, as well, for their continued commitment to serving the Chapter. As a Project Manager, I can tell you firsthand that it's easy to lead great teams, and this is definitely a great team!

I also wanted to extend a special warm welcome to our newest board member, Rachel Gendich. Rachel is a mechanical engineer who was elected as our new Treasurer. Rachel served as the treasurer for her sorority at LTU so we are fortunate to have her experience and energy on The Board.

As you may already know, this year marks our 45th Anniversary. I am looking forward to the upcoming publication of our history book and sharing all the great things we've done over the years. This chapter has always been a role model for the ASPE organization for the value of our educational programs and the contribution of our amazing volunteers – really something to be proud of!

In case you hadn't heard, the big news this month is that the 2020 ASPE Convention has been cancelled. Although we won't all be together in person, I want to assure you that your chapter delegates will be attending the business meetings remotely and are still committed to representing our chapter in the upcoming ASPE National Board elections.

We also have some very sad news to share about one of our legacy members, Barry Pines. Barry passed away recently, and for all those who knew him I'm sure you'll agree that his is a really big loss. Barry was not only a fixture at our chapter meetings and faithful contributor to our technical discussions, he was a guiding light who helped others steer clear of trouble. I can't really express the sadness I feel knowing that he is gone, but I know that the things

Continued on page 2

Contents

President's Report 1 - 2
 Program 3
 In The Know 4
 VP Technical Report 6
 VP Membership Report 7
 Affiliate Liaison Report 8
 ASPE Young Professional Report 10
 Jobs Board 14 - 17
 Photos 20 - 21
 Line Card Sponsors 27 - 28

BOARD MEETING

Virtual Online Meeting 9/1/2020, 4:30 - 5:30 PM

SEPTEMBER PROGRAM

Virtual Online Meeting 9/8/2020, 5:00 - :30 PM

ASPE 2020 CONVENTION

Sept. 11-16, 2020 in New Orleans, Louisiana (see pg. 12)



CPD AND CPDT EXAM AND REGISTRATION

See pg. 12 for scheduling dates.

ASPE IS ACCEPTING APPLICATIONS FOR THE

ALFRED STEELE SCHOLARSHIP

Contact ASPE National for more information at (847) 296-0002, or email info@aspe.org

LATEST NEW MEMBER(S)
~ WELCOME ~
JOSH PEDRAJA
JOHN KUSLUSKI

President's Report (cont. from page 1)

Pam Hartsell, CPD

I learned from Barry will continue to light my way in spirit. Seeing his empty chair for the first time is going to be hard. I already miss him so much!

Of course, I can't neglect to mention COVID-19 and the way is has turned our lives upside down. Thankfully, ASPE National was well prepared to help the local chapters transition to virtual meetings so we could continue to offer the educational programs our members rely on. The hosting services they provided allowed us to make the best of a difficult situation, and that is truly appreciated.

Our next board meeting is scheduled for Sept. 1st, so if you're interested in knowing what goes on behind the scenes, please let me know and I'll send you an invitation. All of our members are encouraged to join the conversations, express their concerns and present their ideas. As EMC Past President John Nussbaum always likes to say - "It's your chapter!" I know I'm looking forward to another great year with my chapter here in Eastern Michigan.

Hope to see you all in person soon!

Your President,
Pam Hartsell

president.aspe.emc@gmail.com

OASIS QUASAR™

UVC-LED WATER TREATMENT.
Exclusively through OASIS

Model Code:
• PWEBQ

Features:

- **Pathogen Control:** UVC-LEDs disinfect the water when it is being dispensed, eliminating the chance of recontamination and reducing 99.99% of pathogens.
- **Pathogen Inactivation:** Effective against a wide range of water-borne pathogens, including Legionella and chlorine resistant micro-organisms such as Cryptosporidium and Giardia.
- **Chemical Free:** UVC-LEDs provide physical treatment of water without the use of harmful chemicals or altering taste.
- **Mercury Free:** Conventional UV lamps contain mercury, a hazardous material which requires special disposal. UVC-LEDs are mercury-free.
- **Freshfield:** Alcove plastic is manufactured with our exclusive silver-based antimicrobial compound to prevent degradation and deterioration caused by bacterial growth.
- **Extremely Low Power:** UVC-LEDs do not transfer heat to the treated water.
- **Constant Protection:** UVC-LEDs pulse on every 10 minutes for a short duration to keep the dispense point sanitized between dispenses.
- **Fail Safe:** Prevents water from dispensing if the QUASAR unit becomes disconnected or fails.
- **Long Life:** Will last three years or more because UVC-LEDs are only on during water dispense or standby mode constant protection.

UVC-LED Treatment right at the point-of-dispense

MD-CHE, UL US, NSF, LEAD FREE

Represented by New Century Sales:

WEST MICHIGAN Michael Zago D (248) 960-1147 x 107 C (616) 293-2121 E mikez@newcenturysales.com	WEST MICHIGAN Rod Cox D (248) 960-1147 x 116 C (616) 706-1481 E rodc@newcenturysales.com	EAST MICHIGAN Todd Hiller D (248) 960-1147 x 106 C (513) 633-2609 E toddh@newcenturysales.com	EAST MICHIGAN Ross Beck D (248) 960-1147 x 115 C (734) 673-2119 E rossb@newcenturysales.com
---	---	--	--

www.newcenturysales.com

SEPTEMBER DESIGN SESSION

5:00-6:00 PM

TOPIC: Plumbing Sizing 101



Bill Grayzar

At times, plumbing design can be intimidating even for people with years of experience. Our first design class of the new season will include a broad overview of the various systems and fixtures associated with plumbing design, and then will delve in to the technical details of domestic water systems and the codes and guidelines used to size them.

Presenter: **William A. Grayzar**, CPD, GPD - Mr. Grayzar is a past president of the Eastern Michigan Chapter of ASPE and currently serves as the chapters V.P. Legislative. He has over 35 years of experience in architecture and engineering. Employed with DiClemente Siegel Design Inc. for over 20 years, Bill continues to enhance his system engineering skills through additional vocational field training. Bill has an excellent working knowledge of Michigan's current building codes and regulations. Bill holds an Associate's Degree of Architectural Technology from Delta College and certifications in Plumbing Design and Green Plumbing Design from ASPE. Bill is active with the National Society of ASPE serving on numerous committees. Bill also serves as the current President of the Code Study and Development Group of Southeast Michigan and is a member of National Fire Protection Association. Bill received the Michigan Chapter of ASSE award as Engineer of the Year in 2013.

SEPTEMBER TECHNICAL PROGRAM

6:00-7:00 PM

TOPIC: Hunter's Curve and the Future of Plumbing Sizing



Dan Cole

This presentation will explain the Hunter method using an estimating curve and fixture units and why Hunter's curves often overestimate actual water demands leading to over-sized plumbing systems. The Water Demand Calculator provides a solution to the problem of overestimating and oversizing water supply systems resulting from current practices required by plumbing codes. Various computational methods

employed in the Calculator were designed to address the low probability of fixture use and the high probability of stagnation (i.e. no water flow) in residential dwellings. The various algorithms allow the prediction of peak flows for the building supply, water meter, principle branches and risers, and fixture supplies. Benefits of using the WDC for estimating peak water demands include reduced construction costs, greater protection from health hazards due to prolonged stagnation and potential microbial (e.g., Legionella) contamination, reduced wait time for hot water delivery, and provision of safe sustainable plumbing systems that encourage water and energy conservation among a broad spectrum of end users.

Presenter: **Dan Cole** is Sr. Director of Technical Services at International Association of Plumbing and Mechanical Officials (IAPMO). He is a licensed Journeyman Plumber in the State of Illinois and member of the American Society of Plumbing Engineers (ASPE). He received the ASPE Scientific Achievement Award in 2018. He has published several articles on Hunter's curve and the fixture unit methodology. His research focus is on the plumbing investigations performed at the National Bureau of Standards (now NIST) with a particular interest in the work of Roy B. Hunter. He also has a focus on promoting water efficiency standards for the built environment.

About Registration and CEUs:

If you are attending virtually: there is a link to register via the ASPE Education page. Please follow all directions. Using this platform for virtual meetings allows us to streamline the CEU process. So all attendees that plan to join virtually, need to register via the corresponding ASPE Education link. Our meetings will also be listed on the ASPE Education calendar, so you can find registration info there as well. <https://education.aspe.org/>

If you will attend in person (when we can offer this option): You will need to register using an Eventbrite link that will be in the email. This allows us to know how many people we can expect in person. Thus, allowing us to make sure we maintain the indoor gathering limits imposed by the Governor, and also order enough food for all. For those that attend in person, we will still require sign in/sign out sheets and your CEUs will be submitted to national within 1 week of our event. It may take up to another 2 weeks for the CEUs to show in your ASPE Education log. The PITC does have guest protocols we will have to obey in order to meet there, so please follow all posted signage and procedures.

IN THE KNOW

NEW CODE BOOK ORDER FORM

Please use the most current book order form from the Code Study & Development Group found in this newsletter. Contact Mr. Dann Holmes with questions at dholmes@nsf.org or (734) 214-6222

TABLE TOP SPONSORSHIP PRICING

ASPE Members

- \$200.00 for the 1st table per meeting/per vendor
- \$150.00 for each additional table per meeting/per vendor

Non-Members

- \$250.00 for the 1st table per meeting/per vendor
- \$200.00 for each additional table meeting/per vendor

If a vendor purchases table tops for 3 meetings during the year, a 4th meeting table top will be provided for free.



Plumbing Engineer

THE OFFICIAL PUBLICATION OF ASPE
American Society of Plumbing Engineers™

IN MEMORY



With great sadness, we announce the passing of Mr. Barry Pines. Barry has touched many lives through his expertise in the Plumbing Industry and Codes and Standards. He was known for his dedication to mentorship and camaraderie, well respected in the industry and had received many awards for his achievements. Barry was a friend to many in the Eastern Michigan ASSE and ASPE associations.

A moment of silence resides here in Barry's memory.

More information will follow as it becomes available.



"Uniting the world plumbing industry and promoting its public health and environmental role"

www.worldplumbingcouncil.com

VP Technical Report

Theresa Card, P.E., CPD, LEED AP BD+C



Hello from your VP Tech!

Wow. What a 2020 it has been, huh? One that I am sure we won't forget, though we would all like to! This pandemic is sure keeping us all on our toes and requiring all those who volunteer for professional societies, or anyone who wants to plan events, to learn new things, be adaptable and ready to pivot directions

all the time! On that note – please always check your email and our website for the most up to date information on our Programs: <https://www.aspe.org/eastern-michigan/program.html>

I would like to again thank all our main presenters from last year, along with Messrs. Mike Melaragni and Paul Baker who always outperform when it comes to the design classes. We hope to continue to provide all our members with valuable information in this year's program – despite the need to accommodate state orders and CDC recommendations.

This year the Chapter will again be providing an early plumbing design class to kick off the evening. This design class series will run from **5:00 PM to 6:00 PM** on the same evenings as the technical meetings, the same as previous years – just time moved back 30 minutes since our attendance at 4:30pm was always lacking. The technical meeting has also slid back and is scheduled to run from 6:30 PM to 7:30PM/8:00 PM. Assuming we can meet in person, at least for a few people, dinner and tabletop vendor product presentations and displays will be provided between the two meetings from 6:00 PM to 6:30 PM. If we go virtual, like we will in September, the timeline will move to just 5PM-6PM – Design Class and 6 PM-7PM Technical Class.

This year each early class will be on a topic related to “Plumbing Systems 101” – we are trying to gear these early sessions towards new grads/college students – so really giving the basics of Plumbing Engineering. Because of this, we will be attempting to always provide a virtual option this year – even if we also allow you attend in person. We are also looking into how to record our meetings and have them available to those who cannot attend live, but still want to gain access to the content. Stay tuned!

The first meeting of this ASPE year will be held on September 8th @ 5PM and will be VIRTUAL ONLY. We will start the evening with a design class taught by Bill Grayzar on the “Plumbing Sizing 101 – Pipe Sizing”.

Then we will move onto our Technical program – “Hunter's Curve and the Future of Plumbing Sizing” by Dan Cole from IAPMO. This is sure to be a great session and has been well received at other Chapters.

How to register for meetings this year? Look to your email! Given the nature of how we need to register differently for different meeting attendance types – I will be sending all meeting notices from the ASPE EMC VPT gmail account. There will be two options/links within each email:

If you are attending virtually: there is a link to register via the ASPE Education page. Please follow all directions. Using this platform for virtual meetings allows us to streamline the CEU process. So all attendees that plan to join virtually, need to register via the corresponding ASPE Education link. Our meetings will also be listed on the ASPE Education calendar, so you can find registration info there as well. <https://education.aspe.org/>

If you will attend in person (when we can offer this option): You will need to register using an Eventbrite link that will be in the email. This allows us to know how many people we can expect in person. Thus, allowing us to make sure we maintain the indoor gathering limits imposed by the Governor, and also order enough food for all. For those that attend in person, we will still require sign in/sign out sheets and your CEUs will be submitted to national within 1 week of our event. It may take up to another 2 weeks for the CEUs to show in your ASPE Education log. The PITS does have guest protocols we will have to obey in order to meet there, so please follow all posted signage and procedures.

We hope you can all be patient with us as we try to provide multiple options for our members to attend our meetings. One of ASPE's greatest benefits is the lasting connections and camaraderie we develop, so we all sincerely hope to be able to meet in person this next Program Year, at some point.

Please read the emails from me and Pam, our new President – and feel free to reach out with any comments, questions, concerns.

I look forward to “seeing” a good showing at our first meeting of this 2020-2021 Program Year!

Sincerely,

Theresa Card

Vpt.aspe.emc@gmail.com



VP Membership Report

Kristin Simoneaux, P.E., CPD, LEED



Welcome back everyone!

I hope you are all staying healthy and cool. We had some changes in our Chapter's board members. As such, I have taken over as VP Membership in lieu of VP Education. If you have any membership questions or know of anyone interested in joining, please

feel free to contact me. If you have any Education questions, I will pass them along to Theresa Card who very graciously took over that position for me so I could take on membership.

We have some exciting new things happening this year in terms of membership. Our chapter is offering a free 1 year student membership to eligible students (up to 10 this 2020-2021 season). In exchange for the free membership, we request the student give feedback on their experience (through either a short interview or writing their own newsletter article) within the first few months of their new membership. If you know of a student that has been contemplating membership, please send them my way!

One of the many benefits to becoming an ASPE member is the mentoring program. If you are interested in becoming a mentor to a plumbing Padawan or wish you had a grey water Gandalf of your very own to help guide you through your plumbing career, please check out our Mentoring Program (<https://connect.aspe.org/aspe-mentor-match/mentoring>). Our ASPE Connect Mentor Match program helps you find, connect, and share experiences with others as either a mentor or mentee.

As most of you know by now, the ASPE/SMSHE healthcare symposium scheduled for last April was postponed. ASPE and SMSHE are investigating the potential of having the event beginning of Spring 2021 so please stay tuned. We will let you know the rescheduled date will be once we have confirmed availability.

Until we meet again, stay healthy!

Kristin Simoneaux P.E., CPD, LEED AP
Associate / Senior Mechanical Engineer
Direct: (248)336-4760
ksimoneaux@stantec.com

Membership Benefits



Handbooks, Technical Books & Manuals



Newsletters, Journals & Reports



Plumbing Engineering & Design Tables App



Member Exclusive Site Section Access



Special Pricing & Discounts



Conventions, Expositions & Symposiums



Earn Continuing Education Units (CEUs)



Alfred Steele Scholarship Program



Local Chapter Affiliation & Meetings



Networking and Leadership Opportunities

Affiliate Liaison Report

Dann Holmes, ASPE Region 2



Shall I Stay or Shall I go...Back to Work?

The Chinese Wuhan coronavirus (aka CoVID-19) continues to impact our daily lives. We have transitioned to virtual meetings, wearing masks to enter any business. Restaurant menus are a mere shadow of what they once were leaving dining options limited,

at best. Have you traveled for business or pleasure and stayed at a hotel lately? A brown-bag breakfast is about the best you'll get.

I'm still working, but from home. I have returned to traveling for business travel but with many unpleasant restrictions. Some of the clients I visit include food & beverage and healthcare facilities and they must be at work. Many plumbing and heating engineers are back in their office. I can tell you, unless someone is alone in their office without their mask on, this practice to control the spread of the Wuhan coronavirus is having a major impact on our personal life and mental acuity.

Building owners are realizing they don't need to have a large facility to conduct business. It is no longer business as usual for any of us. They can sell their real estate and downsize to optimize their operations. They can cancel any planned new construction. They will need to do this soon or the real estate market could collapse before they act leaving many businesses under water.

As I've written about in previous articles, a major reduction in building water usage creates hazardous conditions ripe for waterborne pathogens to grow and corrosion concerns to multiply.

Plumbing systems and associated equipment like cooling towers, pools, decorative fountains, hot tubs, ice machines, drinking fountains, bottle fillers, and kitchen equipment are just a few of the locations you must pay attention to. Going around the building and flushing a few fixtures will not minimize problems that lurk in these pipes.

There is a sequence to flushing that should be executed correctly and it starts with a full understanding of the building water system and the risks associated at every change of direction and usage.

If there hasn't been a continuous call for water at a level that the building was designed for, then there is an increased risk that the floor drains and trench drains may have dried out. This could lead to sewer gases entering the built environment.

Parents with school age children are praying to get their kids back to school and an organized lesson plan. Children, like many of us adults need to engage with friends and colleagues. They need to be mentored. No one wants to admit that this "lock-down" imposed on the citizens of our great country is having a devastating effect on our young. The CDC just released a study that found that 25% of young people have considered suicide during the outbreak.

Do you feel confident the school your children, or grandchildren will return to will be thoroughly assessed for the potential waterborne risks that have taken place during its closure? I would not bet on it.

We must ask ourselves; what are we doing? What are the long-term unintended consequences of our social distancing? To me, the correct term should be physical distancing. We can't visit our elderly, many of whom have been lock up in a nursing home or long-term care facility. I can't imagine what thoughts must be going through their minds. Like, what did I do to deserve this sentencing? I didn't commit a crime. In fact, convicted criminals are being released from prisons but we can't visit our grandparents.

Sadly, this "pandemic" will last until November 3rd at the earliest. One must ask themselves how does a virus know when we vote? When it becomes a political football. Let's get this game over with and really get back to work.

The impact of lessoned learned during CoVID-19 will be referenced by plumbing and mechanical engineers forever.

Dann Holmes – ASPE Region 2 Affiliate Liaison

NSF International – r2al@aspe.org

ASPE Announces The Women of ASPE

The mission of the new Women of ASPE (WOA) special-interest group is to **engage, retain, and advance** women in the plumbing design industry through education, leadership development, and networking opportunities. It is open to women who have an active membership with the American Society of Plumbing Engineers. Some of the activities include:

- Mentoring programs
- Membership growth outreach efforts
- Fostering partnerships with industry-related associations
- Various educational offerings



THE BEST OFFENSE IS A GOOD DEFENSE.

Defend against the test of time and use cast iron soil pipe. Ensure success by knowing when and where to specify cast iron soil pipe. Did you know you can earn CEU's by taking a foundry tour to see how cast iron pipe is made or attend a local lunch and learn? Contact your local technical services manager today.



PLUMBING
TECHNICAL SERVICES

LEARN MORE:
mcwanepumbingtechservices.com



AYP Liaison Report

George Bellman



Hello, fellow ASPE members and Young Professionals. I hope you are doing well and have been staying safe this year. I want to start this article by publicly expressing my condolences to the families of the now 773,152 people who have lost their loved ones to Covid-19. This is an incalculable and heavy loss.

This is not an easy time for anyone. But, despite the negatives of this pandemic, some good has happened. For instance, in my life, I reached out to my family members that I haven't honestly gotten to know. And now feel I have fostered a new relationship with them over these past months. I've instituted family game nights and reconnected with friends I've lost touch with over Zoom. This makes me happy because, in a way, we watch out for each other, even with being hundreds of miles apart.

And from this recent experience, I believe I can continue this outreach of support with my ASPE family. So, I would like to invite the Young Professionals and ASPE members to join me for a JackBox game night on Wednesday, September 16th. This is just a night to relax, connect with others, and have a few laughs. So, I hope to see you on Wednesday and until then stay safe!

ASPE Young Professionals JackBox Game Night

Wednesday, September 16, 5:00-7:00pm

About how to play:

Play using your phone, tablet, laptop, or other web-enabled device as a controller. The main action of the game happens on your TV (or wherever you launched the game) – In our case, through the Zoom meeting platform. Players use their own devices to input answers and make choices.

Join Zoom Meeting

<https://us02web.zoom.us/j/86040197271?pwd=Slowa0duWHE5M0tDWC9Ed1RQU3Fudz09>

Dial by your location

+1 312 626 6799 US (Chicago)

+1 929 205 6099 US (New York)

Meeting ID: 860 4019 7271

Passcode: 903117

Find your local number: <https://us02web.zoom.us/j/kdfG2aNjsZ>

George Bellman, ASPE Region 2 EMC AYP Liaison

gbellman72@gmail.com

Women of ASPE Leadership Forum



The Women of ASPE (WOA) Leadership Forum will be an invaluable learning and networking experience at the 2020 ASPE Convention & Expo. This exclusive event will bring together women in the field of plumbing design who have the opportunity to network with peers, gain knowledge and walk away with actionable insights that can be applied toward professional growth. CEUs are available for participating. Pre-registration is required. [APPLY FOR SCHOLARSHIP](#)

ASPE YOUNG PROFESSIONALS

Hey Young Professionals!

Learn more about our group!



ASPE Young Professionals (AYP) is dedicated to the needs of plumbing engineers and designers 35 years old and younger. Your local ASPE Chapters have been busy organizing exciting opportunities designed to help you excel in your career, including:

- » Partnerships with other associations
- » Social and networking events
- » Educational offerings
- » Mentoring programs
- » And more!



To learn more about the ASPE Young Professionals special-interest group, email ayp@aspe.org and visit aspe.org/ayp.

Exclusive AYP Sponsor





CPDT - 2020 EXAM DATES:

The exam is held annually in the Fall.

2020 CPDT Exam dates: October 5 - 18, 2020 held via remote proctor. For more info go to:

<https://www.aspe.org/education-credentialing/cpdt/>

CPD - 2020 EXAM DATES: The 2021 CPD Exam will be held via remote proctor from April 5 - 18, 2021. Read more about the postponed 2020 CPD Exam due to COVID-19 at:

<https://www.aspe.org/cpdexamcovid19/>



CANCELLED

Given current limitations on travel, the recommendations regarding mass gatherings, and our concern for the health and safety of the ASPE community, we have decided to cancel the 2020 ASPE Convention & Expo event in New Orleans.



EDUCATION



PUBLIC VENUES

COMMERCIAL OFFICES

T&S IS HERE >

T&S is proud to be a trusted name across a wide range of markets — staying at the forefront of today's evolving industry and providing a vast selection of reliable solutions that meet required codes and compliances.

Learn more at tsbrass.com/markets.

Find us in



HEALTHCARE

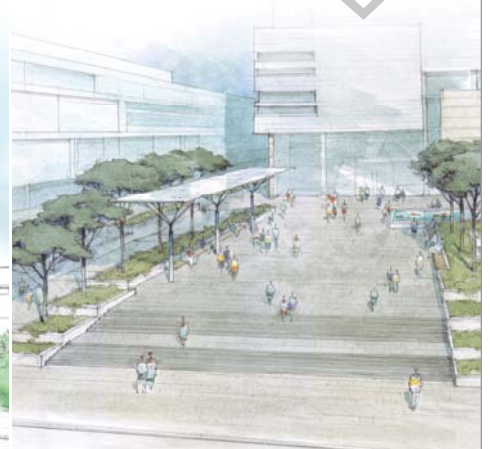

T&S plumbing products represented in Eastern Michigan by: Diversified Spec Sales - 248-398-2400



KIMAX® Glass Drain and Vent Systems

- Low volatile organic compounds (VOCs)
- Will not burn or emit toxic fumes
- Maximum corrosion resistance
- Flexibility, adaptability, modularity
- Safe and simple installation
- Lowest life-cycle costs

Tro Sales Company
3406 West 12 Mile Road
Berkley, MI 48072
(248) 546-5354

SCHOTT North America, Inc
info.drainline@us.schott.com
www.us.schott.com/drainline





"A Relentless Commitment to Excellence"

INSTALLATION, SERVICE & MAINTENANCE SINCE 1970

Project Manager (PM)

Job Competencies and Description

Department: Construction Department

Reports to: Vice President

Supervisory Responsibility:

This position manages field technicians and is responsible for the performance management and accountability of these employees.

Positional Overview:

The Project Manager will plan, execute and finalize projects according to strict deadlines and within budget. This includes acquiring resources and coordinating the efforts of team members and third-party contractors in order to deliver projects according to plan. The Project Manager will also define the project's objectives and oversee quality control throughout its life cycle.

Qualifications:

Required Education and Experience:

1. Associates/Bachelor's degree in a technical discipline, or business management is preferred.
2. 1-2 years of experience in managing or leading the work of others.

Preferred Education and Experience:

1. Five years relevant work experience with an architecture, engineering or construction firm required.
2. Industry Certifications

Competencies:

1. Communication Proficiency
2. Customer/Client Focus
3. Leadership
4. Organizational Skills
5. Performance Management
6. Problem Solving/Analysis
7. Technical Capacity

Additional Eligibility Qualifications:

1. Experience working independently and, in a team-oriented collaborative environment.
2. Can conform to shifting priorities, demands and timelines through analytical and problem-solving.
3. Strong interpersonal skills and communication skills to effectively interface and gain cooperation with all levels of company structure, including outside vendors and General Contractors.
4. Proficient in Microsoft Office (Word & Excel), clearly written proposals, detailed estimating templates for bids and change orders; familiar with project scheduling software.
5. Ability to effectively prioritize and execute tasks in a high-pressure environment is crucial.

Project Manager (PM) – v. 11/1/19

6250 NINETEEN MILE ROAD • STERLING HEIGHTS • MI • 48314 • OFFICE: 586.737.9900 • FAX: 586.737.9901



"A Relentless Commitment to Excellence"

INSTALLATION, SERVICE & MAINTENANCE SINCE 1970

Essential Functions:

1. Direct and manage project development from start to finish.
2. Define project scope, goals and deliverables that support business goals in collaboration with senior management and stakeholders.
3. Ensure project cut sheets, drawings, RFI's and all pre-construction documents are timely submitted.
4. Effectively communicate project expectations to team members and stakeholders in a timely fashion.
5. Estimate the resources and participants needed to achieve project goals.
6. Draft and submit budget proposals and recommend subsequent budget changes where necessary.
7. Determine and assess need for additional staff and make the appropriate recruitments as necessary.
8. Delegate tasks and responsibilities to appropriate personnel.
9. Identify and resolve issues and conflicts within the project team.
10. Plan and schedule project timelines and milestones and interpret various scheduling charts and software.
11. Track project milestones and deliverables; ensure long lead equipment is released timely.
12. Prepare status/progress reports and analyze results – troubleshoot problem areas.
13. Proactively manage changes in project scope, identify potential crises and devise contingency plans.
14. Coach, mentor, motivate and supervise project team members and contractors.
15. Build, develop and grow business relationships vital to success of the project.
16. Conduct project post-mortems and create recommendations report to identify successful and unsuccessful project elements.

Work Environment:

- This position operates in both an office and field setting. This role routinely uses standard office equipment, Microsoft Software and data management software.

Position Type and Expected Hours of Work:

1. This is a full-time (40-50 hour/week) position.
2. The Project Manager is expected to work during all normal business hours, Monday - Friday, 7:00 a.m. to 5:00 p.m., with additional on-call shifts required.
3. Occasional evening and weekend work may be required as job duties demand.

Travel:

- Project Managers are expected to travel to all jobs.

Professional Development Expectations:

- Update job knowledge by participating in educational opportunities, reading professional publications, maintaining personal networks, and participating in professional organizations.

Interested??

Email John Johnson, Vice President
[@jjohnson@macombmechanical.com](mailto:jjohnson@macombmechanical.com)

Project Manager (PM) – v. 11/1/19

6250 NINETEEN MILE ROAD • STERLING HEIGHTS • MI • 48314 • OFFICE: 586.737.9900 • FAX: 586.737.9901



Plumbing Designer

GMB is currently seeking a full time, direct hire Plumbing Designer for our Royal Oak Office. The Plumbing Designer is responsible for leading GMB's design teams in the design of domestic plumbing systems.

What it is like to work here:

We're unique. Sure, every firm says that, but we *know* what makes us unique. We constantly develop well-rounded professionals who become the best at what they do. Our Team of Teams approach provides a linkage between all employees that gives us the ability to think and act as a unit and as we grow allow new employees to be successful at a rapid pace.

At our core we deeply value talent development and opportunities for growth. We continue to build a culture of empowering our employees, giving them opportunities to be the best they can be within a variety of communities, both internal and external, so that we all learn, grow, and give. Whether you come join us in our Michigan offices of Holland, Grand Rapids and Royal Oak or Indianapolis, Indiana, your opportunities are as limitless as your imagination. Come be a part of designing the future.

What you will get to do:

- Utilize your expertise to support GMB with the design of complex plumbing systems.
- Prepare construction documents using Revit.
- Design domestic water, storm water, sanitary drain, waste and vent systems, fuel systems, medical gas systems, and laboratory gas systems.
- Prepare documents and calculations for the LEED certification process.
- Coordinate design efforts working closely with our project teams, clients, and building owners.
- Produce one-line diagrams/schematics, hydraulic calculations of plumbing systems, and calculations in the sizing of plumbing systems and equipment selection.
- Ensure that all drawings are prepared with accuracy, neatness and speed.
- Communicate with team members, other disciplines and outside vendors to obtain necessary information for designs and drawings.
- Assist the design team in the process of assembling organized sets of drawings.
- May assist in data collection and/or field verification, and work in conjunction with our teams of engineers to help develop all aspects of a project.

What are some of the requirements to work for us?

- 5+ years of plumbing design experience.
- Prior experience implementing designs through construction.
- Demonstrated ability to create 3D models, focusing on Plumbing but with the ability to coordinate with all disciplines.
- Ability to manage design of multiple projects/deadlines simultaneously.
- Must possess a technical knowledge base with desire to learn, lead, and grow.
- Must be able and willing to travel locally for field work at client sites.



What might set you apart from other candidates?

- Associates or Bachelor's degree in Plumbing Design / Engineering (or degree related to HVAC Design or Mechanical Engineering) is preferred.
- Proven ability to prioritize effectively, have good follow-through, and practice self-implemented quality control measures.
- CPD certification is a plus.
- Ability to design automatic fire suppression systems.
- Plumbing design experience in A/E firm preferred.
- Proficiency with Autodesk Revit.
- A passion for plumbing design.

This is a direct, full time, permanent position. Salary will be commensurate with experience, including an excellent benefit package. Must have current and continuing right to work in the United States without sponsorship. All qualified applicants will receive consideration for employment without regard to race, color, religion, sex, age, sexual orientation, gender identity or national origin.

**If you are interested, please reach out to:
Rose Wagner
GMB
rosew@gmb.com
616.796.0200**



High Efficiency Water Heaters
High Efficiency Heating Boilers
Custom System Solutions
Storage Tanks

Heating Boilers
Hot Water Supply
Pool/Spa Heaters
Storage Tanks
Complete Parts Stock



Snowmelt Systems
Radiant Floorheat Systems



Residential Water Heaters
Commercial Water Heaters
Storage Tanks
Complete Parts Stock

Natural Gas / Propane / Electric / Oil
3,000 to 4,000,000 BTU's

- ALSO -

Aldrich Boilers / Holby Valves / Valley Water Softeners



Jamie Caporosso: jamie@kerrpump.com
12880 Cloverdale, Oak Park, MI 48237
Ph.: (248) 543-3880 Fax: (248) 543-3236

Liquid Pumps
Vacuum Pumps
Heat Exchangers
Blowers
Related Equipment
and Accessories

Sales • Service • Repair



AURORA FIRE PUMPS

Compact Fire Pump Systems

- UL Listed/FM Approved Aurora Fire Pump
- UL Listed/ FM Approved Fire Pump Controller
- Capacities of 50-750 Gpm.
- Pressures of 40-160 Psi.
- Aurora Model PVM (close coupled to an ODP motor.)

Vertical Split Case Electric Drive Fire Pump

- Electric Driven
- For Commercial, Industrial and Marine use only.
- UL Listed/ FM Approved/NFPA-20 Design

Horizontal Split Case Diesel Drive Fire Pump

- Diesel and Electric driven available.
- Flows at 250 gpm to 5000 gpm.
- Pressures available up to 490 Psi.

PLEASE INQUIRE TO KERR PUMP FOR PRICING,
SELECTIONS, OR TESTING ON EXISTING.

ALSO, PLEASE SEE www.aurorapump.com



Michigan's Oldest Supplier of Pumps and Process Equipment - 1905



Cindy Zatto

Flow Control Solutions

V.E. SALES COMPANY, INC.

For additional information on Aquatherm, Highland Tank, MIRO and Bonomi products, please call Cindy Zatto with V. E. Sales, Inc. at 810.343.2713 or email cindyz@vesalesinc.com



BONOMI
SINCE 1901

Put more than a century of excellence in valve design and production to work for your company

More than 100 years ago, the Bonomi family began designing and manufacturing valves in Italy with the same passion for excellence as the winemakers that were our first customers.

Today, our low-torque ball valves, in sizes 1/4" to 56", and precision electric and pneumatic actuators are still made in Italy in our own advanced production facilities. And though our single-part number valve and actuator packages make valve automation more simple than ever, our engineering support is available world wide.

Call Bonomi. We'll put our history of flow-control excellence to work for your future.



www.bonominorthamerica.com • (704) 412-9031

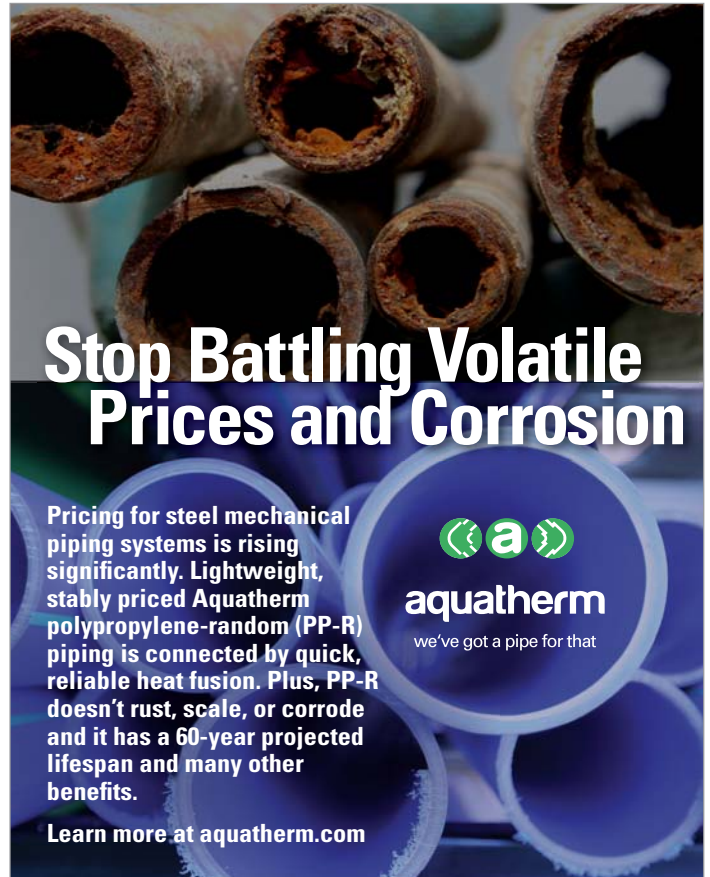

Stop Battling Volatile Prices and Corrosion

Pricing for steel mechanical piping systems is rising significantly. Lightweight, stably priced Aquatherm polypropylene-random (PP-R) piping is connected by quick, reliable heat fusion. Plus, PP-R doesn't rust, scale, or corrode and it has a 60-year projected lifespan and many other benefits.

aquatherm
we've got a pipe for that

Learn more at aquatherm.com

PROBLEM:

RPZ inside a building
= flood damage
= design engineer liability

SOLUTION:

Install the RPZ inside a freeze protected enclosure located outside the building.

Want to learn more?

Visit the engineering blog pages at www.safe-t-cover.com/blog



SAFE-T-COVER
BY HYDROCOWL

safe-t-cover.com 800-245-6333

PROUDLY MADE IN THE USA
WWW.MIROIND.COM

THE SIMPLE, SMART SOLUTION TO ROOFTOP SUPPORTS



- ✓ Industry-leading 20 year warranty
- ✓ Designed to protect roof membrane by keeping PSI below 2.0
- ✓ Supports come pre-assembled and ready to install
- ✓ Supports available for duct, pipe, mechanical units, and more, as well as stair crossovers, ramps, and service platforms
- ✓ Professional assistance through the process, from take-off to final installation

MIRO
INDUSTRIES, INC.
ROOFTOP SUPPORT PRODUCTS

HOW CAN WE SUPPORT YOU?

SUMMER PHOTOS



Theresa Card sent a photo of some of her girls! All have just started laying eggs 🥚, so they don't have names, just black, buff and brown chicken. These look like some happy hens!



Rachel Gendich got married! Congrats to Rachel and her husband!

SUMMER PHOTOS



Pam Hartsell sent in a few photos: This one is titled "My youngest daughter got engaged" CONGRATS TO THE HAPPY COUPLE!



"My youngest kid outgrew me"
Just look at those smiles :)

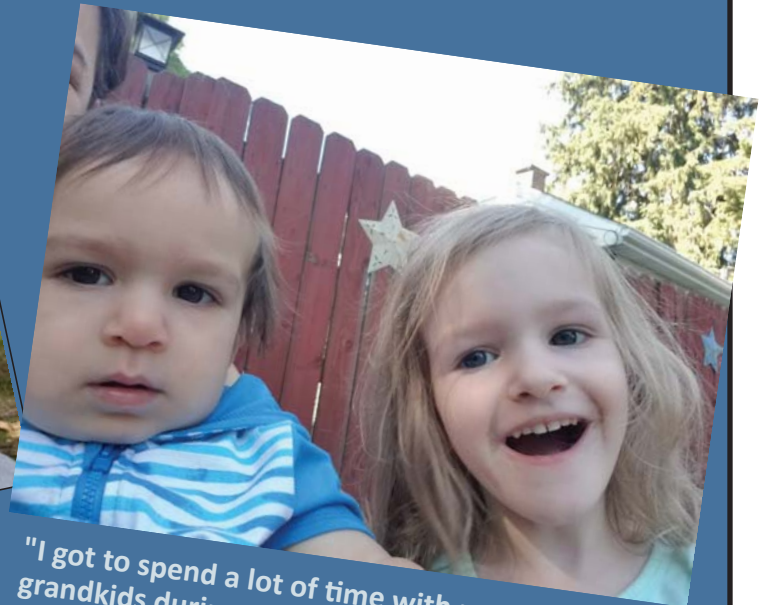

"I got to spend a lot of time with my grandkids during quarantine"
Cuteness overload!!!

Viega System Solutions

Multiple materials, many solutions
One provider



For more information, contact:

Carl Petitt, Jr.
Technical Manager - Great Lakes
carl.petitt@viega.us
(614) 852-2691

Michael Norgan
District Sales Manager
michael.norgan@viega.us
(989) 415-2431



www.viega.us

ALL-IN-ONE SCALD PROTECTION



Certified!



420-T Series

Now there's no need to install a thermostatic mixing valve below the sink. The new 420-T Series combines Chicago Faucets durability with integrated scald protection. The result is a solid, easy-to-install restroom faucet that complies with ASSE 1070 requirements. With the 420-T, everything you need to meet current building codes and protect users against scalding is built right into the faucet.

Visit chicagofaucets.com or call your local representative for more information.

Taggart-Knight Group
248/553-4388
info@taggartknight.com





[calQlate Your Potential Energy Savings]

Booster system sizing can be difficult. That's why there's calQflo.

QuantumFlo's advanced innovation makes us the premier industrial manufacturing and distribution leader of intelligent pump system technology.

We offer the industry's revolutionary online booster system sizing software, calQflo, that selects the most efficient booster option for your needs—so that your system keeps pumping long into the future! With calQflo, you can:

- Compute the most **size-appropriate** system for your projects.
- **Save money** by selecting **energy-efficient** specs.
- Gain all of this information for **free!**



Get 20-50% Potential Energy Savings from Standard Sizing



Quality Water & Air, Inc.

Quality Water & Air, Inc.
 1402 Souter
 Troy, MI 48083
 Phone: 248-589-8010
 Email: qualitywaterair@cs.com
 Website: www.qualitywaterair.com
 Contact: Georgann - Chuck - Paul

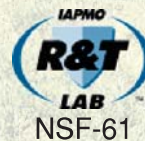

Every Panel Meets UL508A with a 100KAIC (SCCR) Withstand Rating

NEW CENTURY SALES, INC.

MANUFACTURERS REPRESENTATIVES

MB&A
MEEK | BECK & ASSOCIATES INC.



www.americanstandard-us.com
(Kitchen & Bathroom)



www.amtrol.com
(Expansion Tanks)



www.anaheimmfg.com
(Garbage Disposals)



www.bascoshowerdoor.com
(Shower Doors)



www.bradleycorp.com
(Washroom Solutions)



www.caleffi.com
(Hydronic Accessories)



www.fiatproducts.com
(Shower Floors)



www.grohe.com/us
(Faucets)



www.usa.ibcboiler.com
(Boilers)



www.justmfg.com
(Stainless Steel Sinks)



www.femyers.com
(Water and Waste Pumps)



www.oasisbath.com
(Fiberglass & Acrylic Tub & Showers)



www.oasiscoolers.com
(Water Filtration Coolers)



www.oatey.com
(Cherne, Dbn Brass, Harvey & Hercules)



<https://na.panasonic.com/us/home-living-solutions/ventilation-indoor-air-quality/>
(Bath Fans)



www.rehau.com/us-en
(PEX Plumbing Products)



www.rheem.com
(Water Heaters)



Represented by New Century Sales:

<p>WEST MICHIGAN Michael Zago C (616) 293-2121 E mikez@newcenturysales.com</p>	<p>WEST MICHIGAN Rod Cox C (616) 706-1481 E rodc@newcenturysales.com</p>	<p>EAST MICHIGAN Todd Hiler C (513) 633-2609 E toddh@newcenturysales.com</p>	<p>EAST MICHIGAN Ross Beck C (734) 673-2119 E rossb@newcenturysales.com</p>
--	---	--	---

www.newcenturysales.com

ASPE Mentoring Program

The Women of ASPE are excited to introduce ASPE's new Mentoring Program!

This program, which is available to all members of the Society, has been designed to connect ASPE members who have a particular skill set (mentor) with individuals (mentee) who are searching to acquire the same skills to develop and make progress toward their personal and professional goals.

Who Is a Mentor?

A mentor is someone who can help the mentee develop skills for success and long-range career planning, is able to be a good listener, is willing to share experiences and views, is willing to commit time and effort, provides an "open door" to questions and problems, points out both strengths and opportunities for improvement, and has a vested interest in the growth and development of their mentee.

Benefits to the mentor:

- Satisfaction in helping someone mature, progress, and achieve goals
- Meeting and sharing experiences with other mentors
- Personal ongoing support to help the mentee succeed
- Personal fulfillment through contribution to the Society and the individual

Who Is a Mentee?

Having a mentor can contribute to a successful and satisfying career. Without a mentor, that learning occurs mostly through trial and error. With a mentor, even experienced professionals can benefit from the experiences and expertise of someone who has withstood the trial and can help the mentee avoid the mistakes. Similarly, those new to the industry will discover that being a mentee shortens the learning curve for acquiring the skills and knowledge most critical to a fruitful career.

Benefits to the mentee:

- Discover new talents about yourself
- Career satisfaction
- Expand your personal network
- Maximize your strengths

aspe.org/aspe-mentoring-program



INTRODUCING THE FREEZELESS **UNDERCOVER** WALL HYDRANT™



- Model 68 freezeless wall hydrant protected by an integral cover
- Drains automatically—even with hose attached
- Replaceable 16 gauge stainless steel cover flips down for easy access
- Tee key prevents unauthorized use
- Sleek, streamlined, low profile design



WOODFORD MANUFACTURING COMPANY

Excellence. *Always.*

800.621.6032 • www.woodfordmfg.com

Represented by Burke Agency, Inc. • 248.669.2800

Woodford Model 68

BALFREY & JOHNSTON, INC.

Manufacturers' Representatives
13050 Northend
Oak Park, MI 48237
Ph 313 864-2800 Fax 313 864-7219
George D. Johnston: george@balfrey-johnston.com
balfrey-johnston.com

KERR PUMP AND SUPPLY

Manufacturers' Representatives
12880 Cloverdale
Oak Park, MI 48237
Ph 248 543-3880 Fax 248 543-3236
Jamie Caporosso: jamie@kerrpump.com
kerrpump.com

BURKE AGENCY, INC.

Manufacturers' Representatives
2605 E. Oakley Park Road, Suite A,
Commerce Twp, MI 48390
Ph 248 669-2800 Fax 248 669-3310
Brian Burke, Peter Lapham, John Taylor
bburke@burkeagency.com
burkeagency.com

LOCHINVAR

High Efficiency Water Heaters and Boilers
45900 Port Street
Plymouth, MI 48170
Ph 734 454-4480 Fax 734 454-1790
Jason Loverich: jloverich@lochinvar.com
lochinvar.com

DALE PRENTICE COMPANY

Manufacturers' Representatives &
Application Engineering Solutions Provider
26511 Harding Avenue
Oak Park, MI 48237
Ph 800 536-4700 Fax 248 339-5559
Michael Cullen: mcullen@prenticeco.com
Mobile 248 302-5924
prenticeco.com

MAJOR/LOZUAWAY & ASSOCIATES, INC.

Manufacturers' Representatives
1117 W. Grand Blanc Rd.
Grand Blanc, MI 48439
Ph 810 234-1635 Fax 810 234-8389
Mike Ostrowski: moski@lozuaway.com
Mobile 810 287-6983

DAVE WATSON ASSOCIATES, INC.

Manufacturers' Representatives
1325 W. Beecher St.
Adrian, MI 49221
Ph 517 263-8988 Fax 517 263-2328
Rick Johnston: rjohnston@davewatson.biz
davewatson.biz

NEW CENTURY SALES - MEEK/BECK & ASSOC.

Manufacturers' Representatives
1715 Traditional Dr.
Commerce Township, MI 48390
Ph 248 960-1147
Todd Hiler: toddh@newcenturysales.com
Mobile 513 633-2609
Ross Beck: rossb@newcenturysales.com
Mobile (734) 673-2119
newcenturysales.com

**DIVERSIFIED SPEC. SALES, INC./
HOWLEY AGENCY SALES CO.**

Manufacturers' Representative
13261 Northend Ave.
Oak Park, MI 48237-3265
Michael J. Burdette: mburdette@dsshowley.com
Ph 248 398-2400 Fax 248 547-4905
diversifiedspec.com

PAULA. BAKER

ASSE Region #4 Director - Mid West
ASSE International
18927 Hickory Creek Drive, Suite 220
Mokena, IL 60448
Ph 313 399-3072 Fax 248 585-1437
Paul Baker: paul.baker@ualocal98jatc.org
www.asse-plumbing.org

HS/BUY VAN ASSOCIATES, INC.

Manufacturers' Representatives
56 S. Squirrel
Auburn Hills, MI 48326
Jarrett Armstrong, Bill Allen
Ph 888 472-8982 Fax 248 852-0298
info@hsbuyvan.com
hsbuyvan.com

PERFORMANCE ENGINEERING GROUP

Engineered Water Products
32955 Industrial Rd.
Livonia, MI 48150
Alan Deal: adeal@performanceengineering.com
Ph 734 266-5300 Fax 734 266-5310
performanceengineering.com

PROGRESSIVE MARKETING & SALES INC.

Manufacturers' Representatives
7450 Hessler Dr. Rockford Mi 49341

Dave Andrus 616-916-4140 andrus.progressive@gmail.com
Matt Johnson 517-614-1448 mjohnson.progressive@gmail.com
Doug Shaffer 248-648-0187 shaffer.progressive@gmail.com
progressivemarketingandsales.com

R.L. DEPPMANN COMPANY

Manufacturers' Representatives
46575 Magellan Drive
Novi, MI 48377

Gerry Potapa Jr., CPD, Paul Prentice, LEED AP®
Mark Fine, LEED AP®, Chris Lieder
Ph 800 589-6120 Fax 248 354-3763
sales@deppmann.com
deppmann.com

PROGRESSIVE PLUMBING SUPPLY

Wholesale Distributor
31239 Mound Road
Warren, MI 48092
Ph 586 756-8662 Fax 586 756-9077
ppsapplyco.com
Locations: Warren, Detroit, Mt. Clemens, and Oxford

TAGGART-KNIGHT GROUP

Manufacturers' Representatives
37686 Enterprise Ct.
Farmington Hills, MI 48331
Gary O. Taggart
Ph 248 553-4388 Fax 248 553-4653
info@taggartco.com
taggartknight.com

QUALITY WATER & AIR, INC.

Manufacturers' Representative
1402 Souter
Troy, MI 48083
Georgann Kummer, WBE
Ph 248 589-8010 Fax 248 589-8016
qualitywaterair@cs.com
qualitywaterair.com

V. E. SALES COMPANY

V. E. Sales is your source for
the finest quality flow control solutions.
25200 Jefferson Ave.
St. Clair Shores, MI 48081
Thomas Van Egmond
Ph 586 774-7760 Fax 586 774-1490
vesalesinc.com

Expand
YOUR COMPANY
Place your ad here.



ASPE EMC WILL BE HOLDING A VIRTUAL MEETING THIS MONTH

2020-2021 ASPE EMC Board

President

Pam Hartsell, CPD
Strategic Energy Solutions
4000 W. Eleven Mile Rd.
Berkley, MI 48072
(248) 399-1900 x 222
Fax: 399-1901
p_hartsell@yahoo.com

VP Technical

Theresa Card, P.E., CPD,
LEED AP BD+C
Strategic Energy Solutions
4000 West 11 Mile Rd
Berkley, MI 48072
(248) 399-1900 ext 223
allethe@gmail.com

VP Legislative

William Grayzar, CPD
28150 Greenfield Rd.
Southfield, MI 48076
(248)569-1430 ext.333
bill@dsonline.com

VP Membership

Kristin Simoneaux, P.E., CPD,
LEED AP
2338 Coolidge Hwy. #100
Berkley, MI 48072
(248) 336-4700
kristin.simoneaux@stantec.com

VP Education

Theresa Card, P.E., CPD,
LEED AP BD+C
Strategic Energy Solutions
4000 West 11 Mile Rd
Berkley, MI 48072
(248) 399-1900 ext 223
allethe@gmail.com

Treasurer

Rachel Gendich
Strategic Energy Solutions
4000 W. Eleven Mile Rd.
Berkley, MI 48072
(248) 399-1900
Fax: 399-1901
rgendich@sesnet.com

Administrative Secretary

Brianne Hall, P.E., CPD,
LEED AP BD+C, GGP
FTC&H
39500 Mac Kenzie Dr. Suite 100
Novi, MI 48377
(248) 324-4780
bnhall@ftch.com

Corresponding Secretary

George Johnston II
13050 Northend Ave
Oak Park, MI 48237
(313) 864-2800 Fax: 864-7219
george2@balfrey-johnston.com

Chaper Affiliate/Liaison

Dann Holmes
NSF International
789 N. Dixboro Rd
Ann Arbor, MI 48105
(734) 214-6222
r2al@aspe.org

AYP Liaison

George Bellman
Strategic Energy Solutions
4000 W. Eleven Mile Rd.
Berkley, MI 48072
(248) 399-1900 x222
Gbellman72@gmail.com

WOA Liaison

Theresa Card, P.E., CPD,
LEED AP BD+C
Strategic Energy Solutions
4000 West 11 Mile Rd
Berkley, MI 48072
(248) 399-1900 ext 223
allethe@gmail.com

Directors

Michael Melaragni, CPD
38958 Lapham Drive | Livonia, MI
48154-1014
(734) 591-9339
mjmelaragni@yahoo.com

Kari Rosteck
(313) 318-6555
kari.rosteck@gmail.com

John Nussbaum,
IPP, FASSE, FASPE

ADVERTISING OPPORTUNITY INFORMATION

ASPE EMC News is published 9 times per year (September through May, plus one summer issue if feasible). Yearly advertising rates are \$200.00 per ad for members and \$250.00 for non-members. One time digital full page insert advertisements are \$250.00 for one issue, quarter page (9 issues) \$250.00 - half page (9 issues) \$350.00 and full page (9 issues) \$550.00. Please call Pam Hartsell at (248) 399-1900 x 222 for any questions regarding pricing of ads. Checks should be made payable to ASPE E. Mich. Chapter and mailed to the attention of Pam Hartsell, CPD at Strategic Energy Solution, 4000 W. Eleven Mile Rd. Berkley, MI 48072 . Circulation 400 - Distributed to: Engineers, Contractors, Inspectors, and other industry professionals in Michigan. For contributing articles and all digital artwork email to: Theresa Green, Newsletter Editor at: theresa.m.green@outlook.com

TABLE TOP SPONSORSHIP INFO

ASPE Members

- \$200.00 for the 1st table per meeting/per vendor
- \$150.00 for each additional table per meeting/per vendor

Non-Members

- \$250.00 for the 1st table per meeting/per vendor
- \$200.00 for each additional table meeting/per vendor

If a vendor purchases table tops for 3 meetings during the year, a 4th meeting table top will be provided for free.



PAY FAST, PAY EASY
Secure Payments Accepted By

